

# QS13 Fingerprint Deadbolt Lock

QS13



Fingerprint Recognition



Decoy Password Feature



Anti-Pulse Attack



Local alarm



Guest function



## Decoy Password Feature

Allows random digits before or after the real password to prevent prying, enhancing password security.



## Anti-Pulse Attack

Utilizes electromagnetic shielding and detection technologies to resist strong electromagnetic interference, ensuring stable operation.

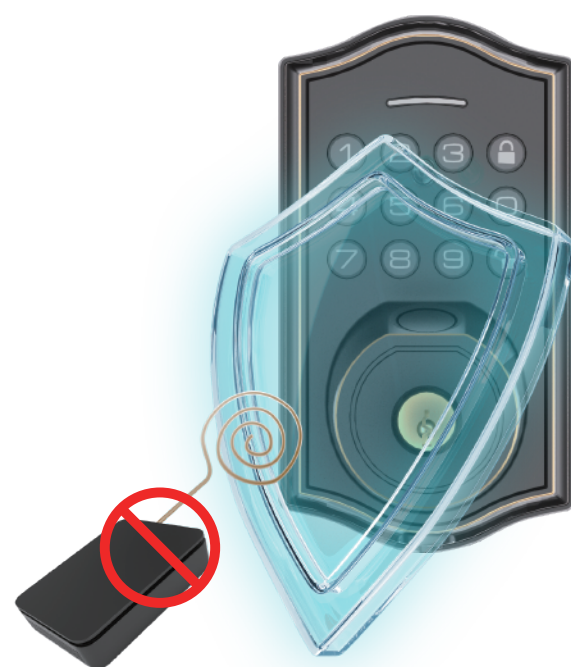

## Local alarm

Locks the device and triggers an alarm after multiple failed attempts, preventing brute-force attacks and enhancing security.

## Guest function

One-time password, randomly generated key, used once invalid;  
Periodic password, be used within a specified period of a fixed period.



# Technical Specifications

Unlocking Modes	Fingerprint/PIN code/BLE APP Unlock/Mechanical Key/Remote Optional(Support Dual Verification)
Fingerprint Capacity	50 groups
PIN Code Capacity	100 groups
Wireless Standards	Bluetooth
Power Supply	4*AA batteries 6V
Battery Life	AA battery: 12 months (unlocking 10 times a day)
Emergency Power	Type-C port for emergency charging
Material	Zinc alloy
Working Temperature	-20°C~55°C
Door Category	Wood, Composite, metal, Anti-Burglary Door
Door Thickness	35mm-55mm
Product Size	Front panel: 133.4*73.4*33.0mm Rear panel: 174.2*76.5*50.0mm

## App Features

- Basic Setup: Volume/language/PIN Code/On-Off
- User Management: Assign roles (Admin, Regular, Guest)
- Activity Logs: View unlocking/locking history with timestamps
- Custom Schedules: Set access times for specific users

# Package Contents

- 1 x Smart Lock Front Panel
- 1 x Back Panel
- 1 x Lock Body (Size as per model)
- 1 x Installation Toolkit
- 1 x Quick installation Guide

